

HOW TO MEASURE FOR SHADE SAILS

Which Shade Sail Shape is suitable for me?

The choice of a three-sided, four-sided, or five-sided shade sail depends layout of your space, the purpose of the shade sail and the amount of shading you require from the shade sails.

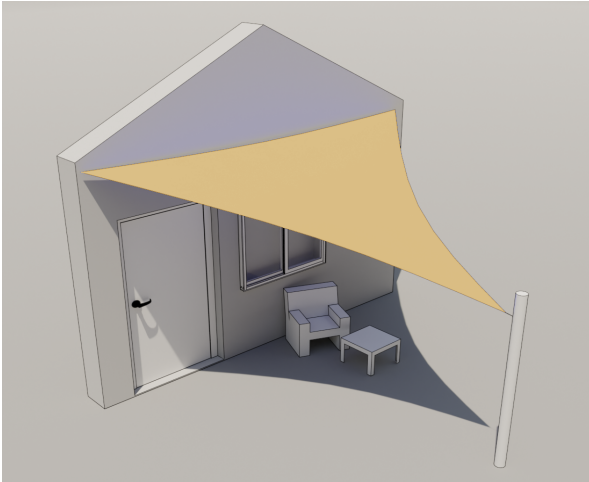

Three Sided Shade Sail

A three-sided shade sail is suitable when you have only three anchor points available, in the form of walls or poles. It provides shade and coverage in a triangular shape but has one of the best aesthetic appeal as it looks very stylish. Many customer prefer to combine to triangular shade sails, installed in opposite directions to create a stylish look as well as provide extra shade.

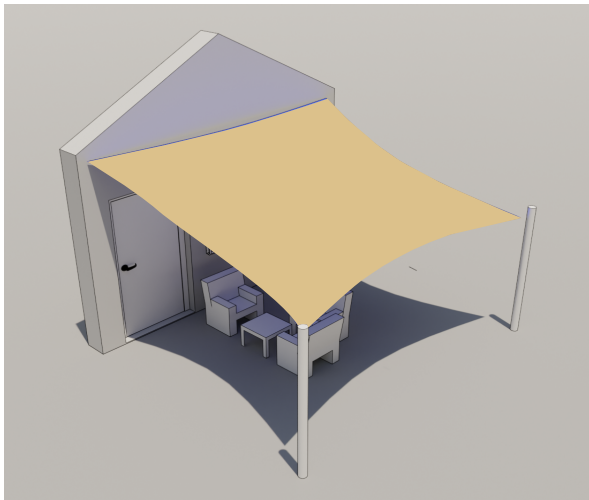

Four Sided Shade Sail

A four-sided shade sail is the most commonly used shade sail and is installed using four anchor points. It provides a square or rectangular shaded area depending on the angle of the sun. It is important to fasten four sided shade sails with good tension so that they do not flap in windy conditions and offer greater life and stability.

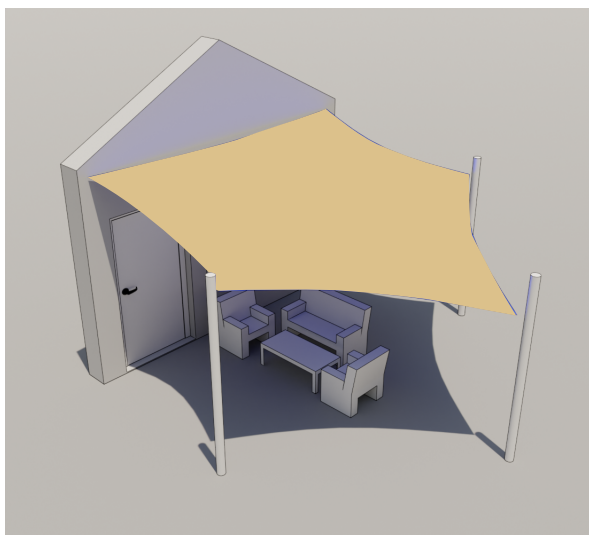

Five Sided Shade Sail

A five-sided shade sail is useful when you have five anchor points, forming a pentagon shape. This option offers a unique design and can provide shade in irregular or angled spaces. This is a new introduction in the shade sail market and rarely seen. This shade sail is often used to cover outdoor seating areas as it is a good combination of style and great shading.

How to measure for Three sided Shade Sail ?

(without additional accessories)

When measuring the size of a three-sided shade sail, it's important to consider the following steps:

Leave a 1ft to 2ft (30cm to 60cm) distance between the shade sail and the supporting pole or anchor point. This gap allows for future tightening of the shade sail as the fabric may stretch over time.

Measure each side of the shade sail in centimeters (cm). Start at the anchor point and measure along the edge of the shade sail to the next anchor point. Repeat this for all three sides (A-B, B-C, C-A), recording the dimensions accurately.

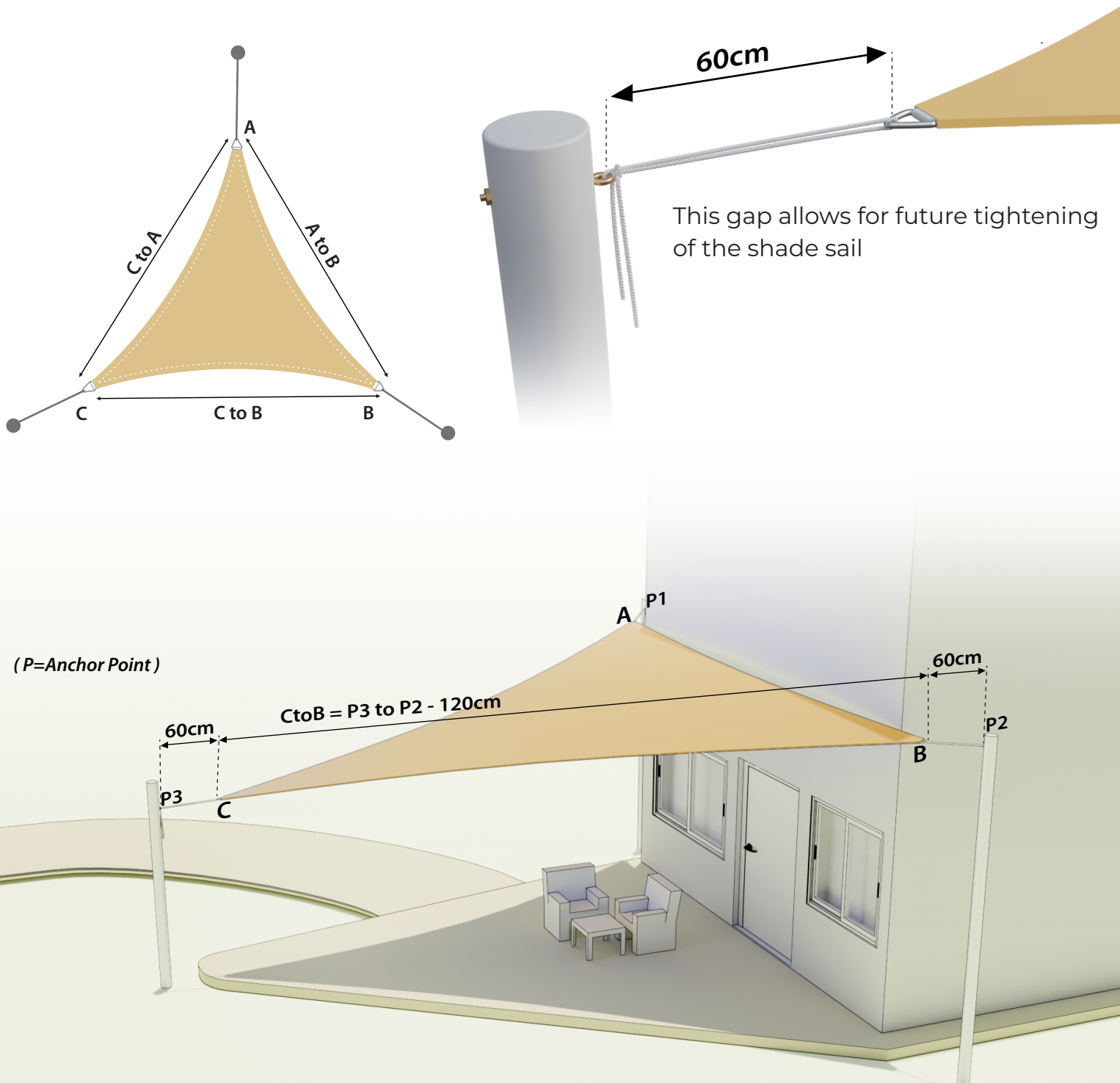

By following these steps and providing the measurements in centimeters for all three sides, you can ensure a proper fit and effective installation of the three-sided shade sail.

How to measure for Four sided Shade Sail ?

(without additional accessories)

When measuring the size of a four-sided shade sail, it is important to consider the following steps:

Leave a 1ft to 2ft (30cm to 60cm) distance between the shade sail and the supporting pole or anchor point. This gap allows for future tightening of the shade sail as the fabric may stretch over time. It also ensures proper tension during installation.

Measure each side of the shade sail in centimeters (cm). Start at point A and measure to point B, then from B to C, C to D, and finally from D back to A. Record these dimensions accurately for all four sides.

Additionally, you may also measure the diagonal distance from point A to point D. This measurement is optional but can be helpful in creating the exact structure as per your needs.

By following these steps and providing the measurements in centimeters for all sides (a-b, b-c, c-d, d-a), along with the optional diagonal (a-d), you can ensure a proper fit and precise installation of the four-sided shade sail.

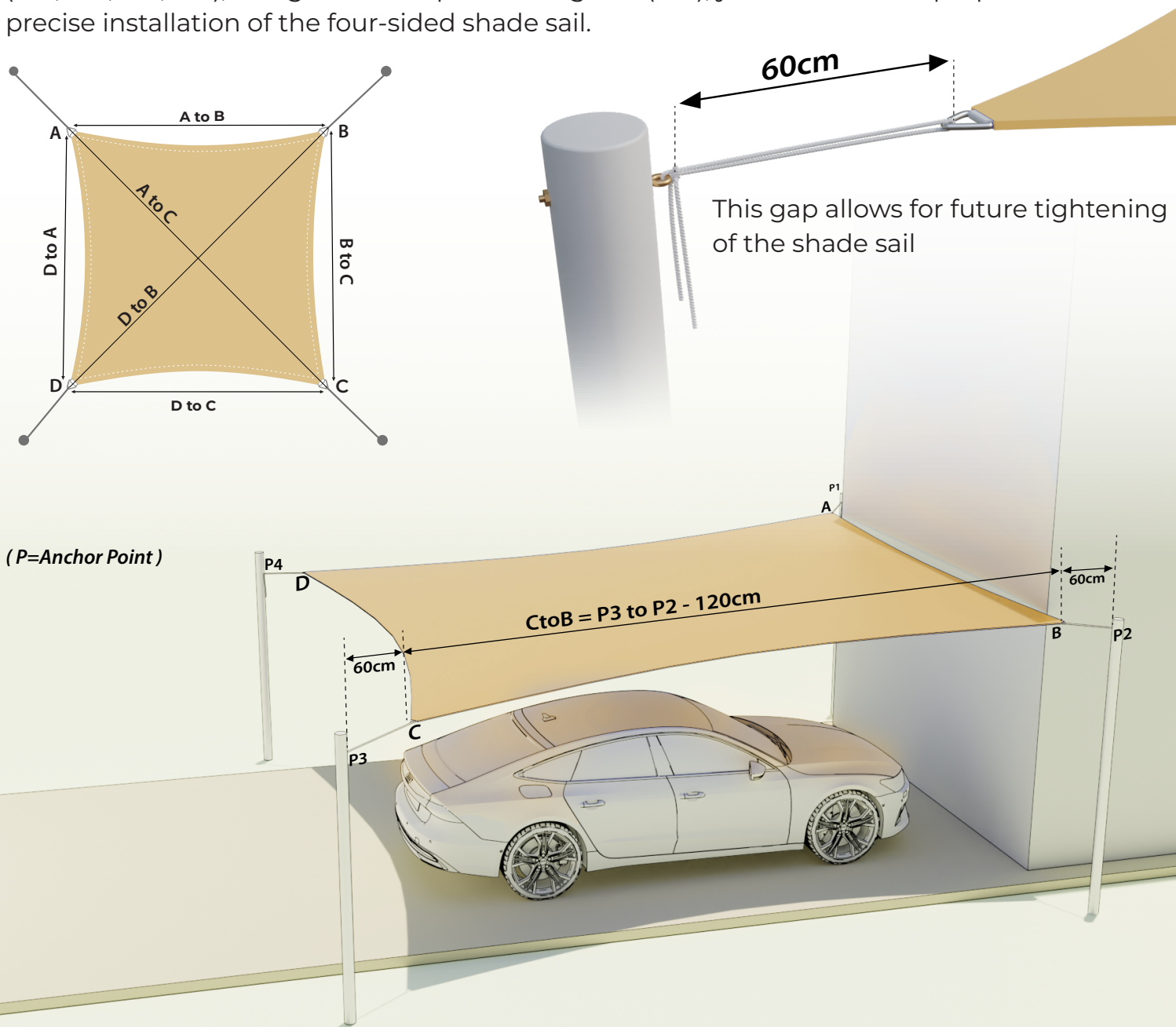

How to measure for Five sided Shade Sail ?

(without additional accessories)

When measuring the size of a five-sided shade sail, it is important to consider the following steps:

Leave a 1ft to 2ft (30cm to 60cm) distance between the shade sail and the supporting pole or anchor point. This gap allows for future tightening of the shade sail as the fabric may stretch over time. It also ensures proper tension during installation.

Measure each side of the shade sail in centimeters (cm). Start at point A and measure to point B, then from B to C, C to D, D to E, and finally from E back to A. Record these dimensions accurately for all five sides (A-B, B-C, C-D, D-E, E-A).

Additionally, you will need to provide the measurements for two diagonals. Measure the distance from point A to point C and from point A to point D. These diagonal measurements (a-c and a-d) are mandatory to ensure accurate construction of the shade sail.

By following these steps and providing the measurements in centimeters for all sides (A-B, B-C, C-D, D-E, E-A) along with the diagonals (a-c and a-d), you can ensure a proper fit and precise installation of the five-sided shade sail.

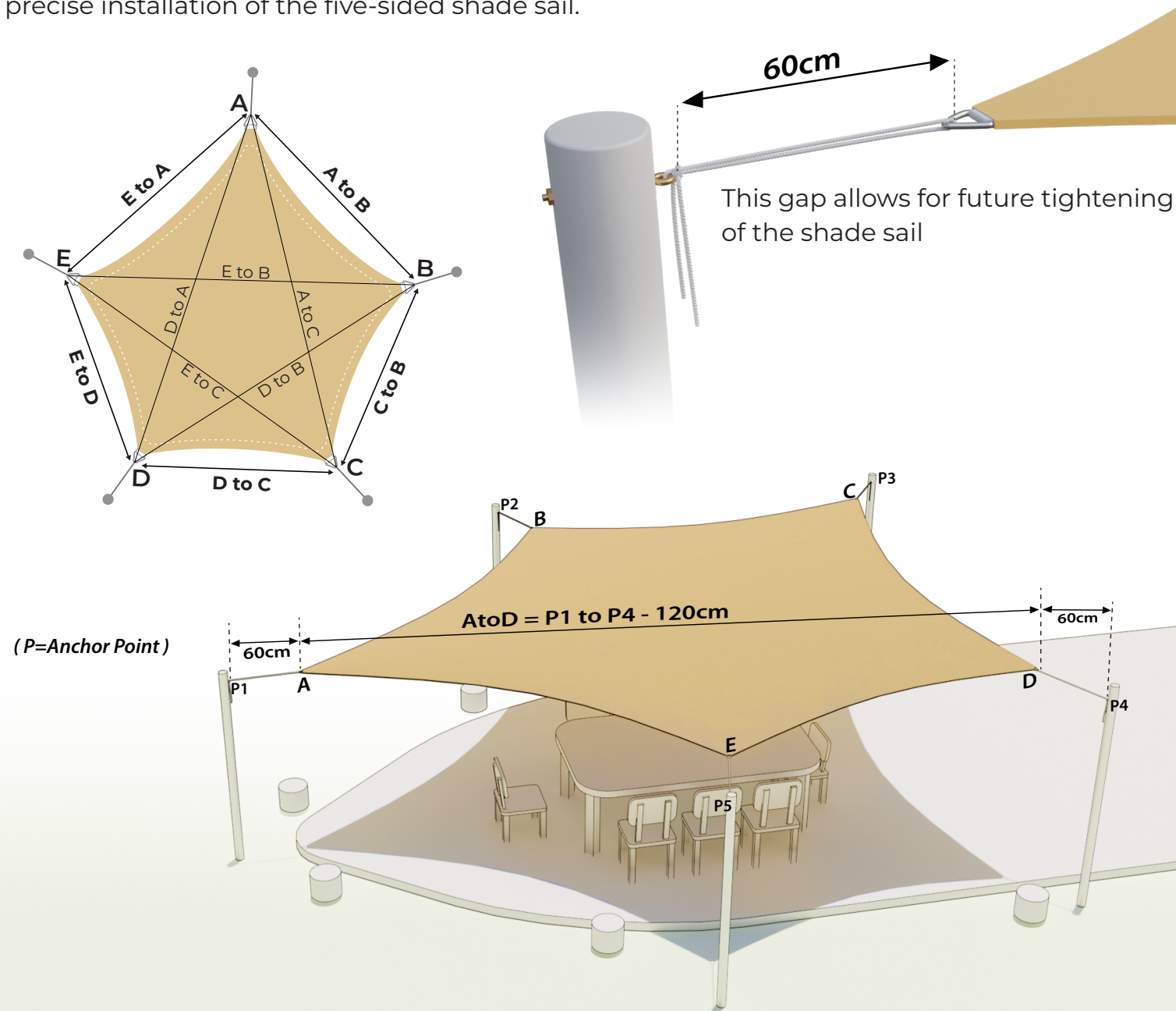

Sizes of Accessories



Brass wall fasteners



D- Shackles

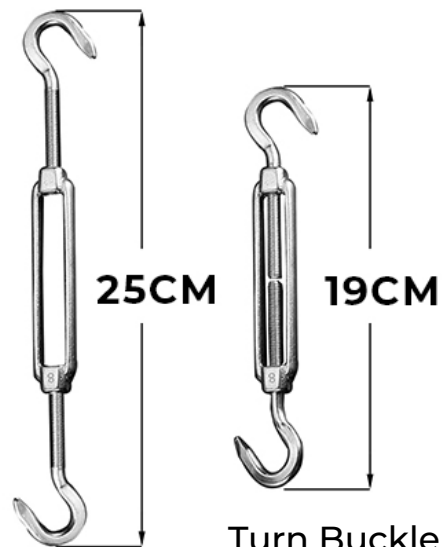

Turn Buckle

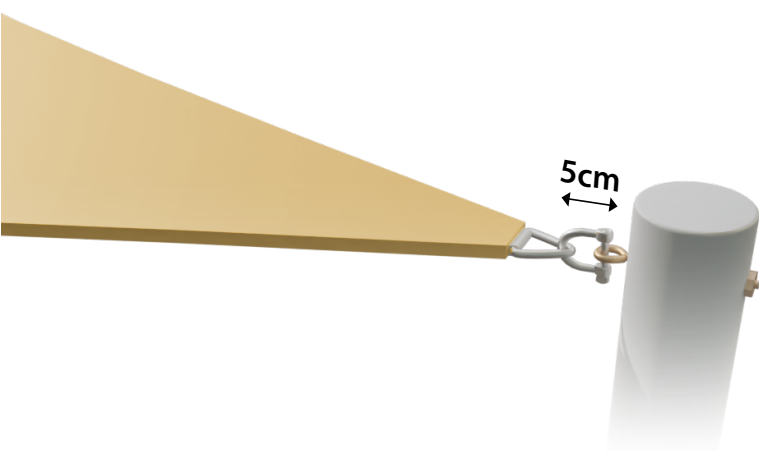

Leave a 5 cm gap between the two anchor points where the D-shackles will be attached. This allows for proper installation.

Leave a 25 cm distance between one anchor point and the shade sail buckle. This accounts for slight fabric stretching.

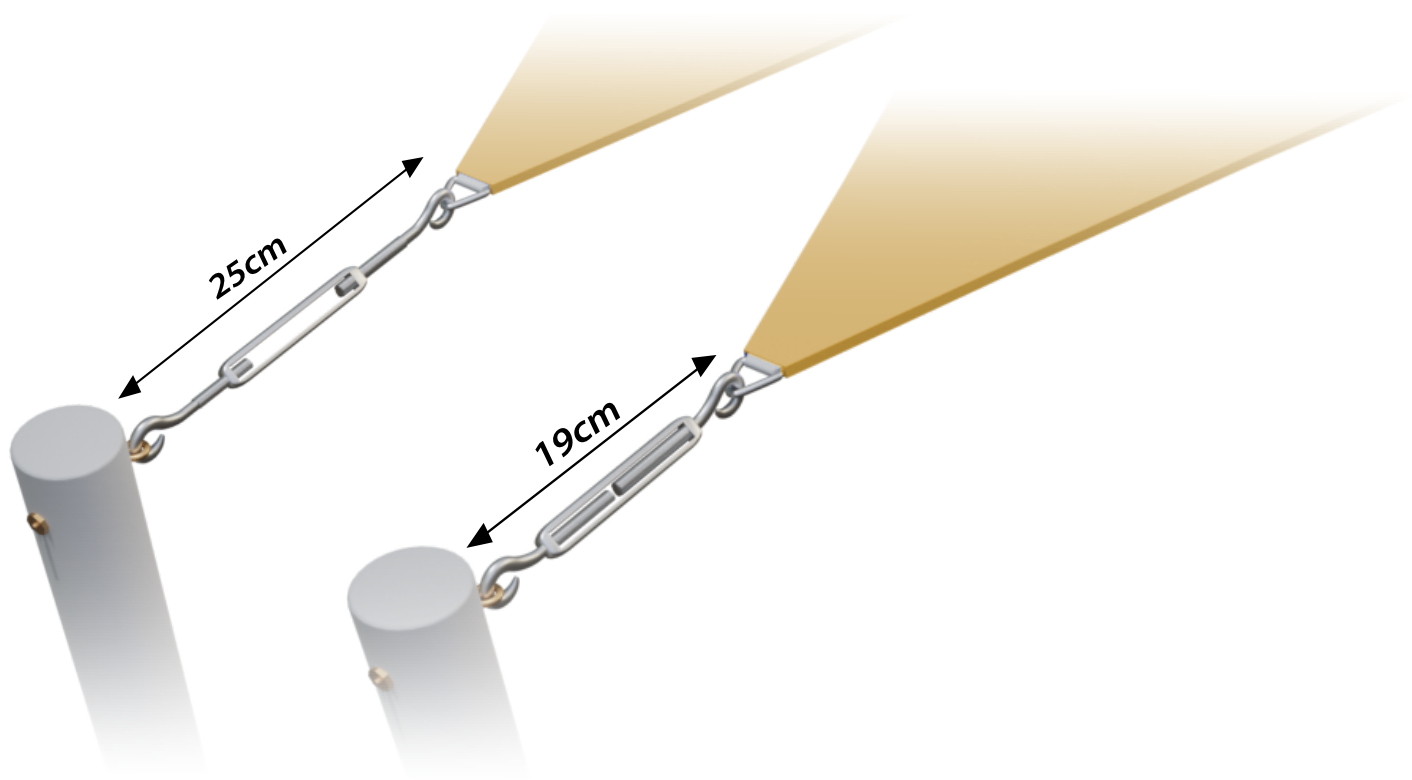

How to measure for Three sided Shade Sail ?

(with additional accessories Turnbuckle & D-Shackle)

For a triangular shade sail, it is recommended to use a d-shackle on two corners and a turnbuckle on one corner. This provides stability and adjustability.

Leave a 25 cm distance between one anchor point and the shade sail buckle. This accounts for slight fabric stretching.

Leave a 5 cm gap between the two anchor points where the d-shackles will be attached. This allows for proper installation.

For example, if you want to cover an area of 400cm x 400cm x 400cm, then the measurement for the shade sail will be A-B should be 390cm, B-C should be 390cm, and C-A should be 375cm.

Attach the shade sail directly to corners A and B without any gaps. Use a turnbuckle on corner C to provide tension and adjustability to the shade sail.

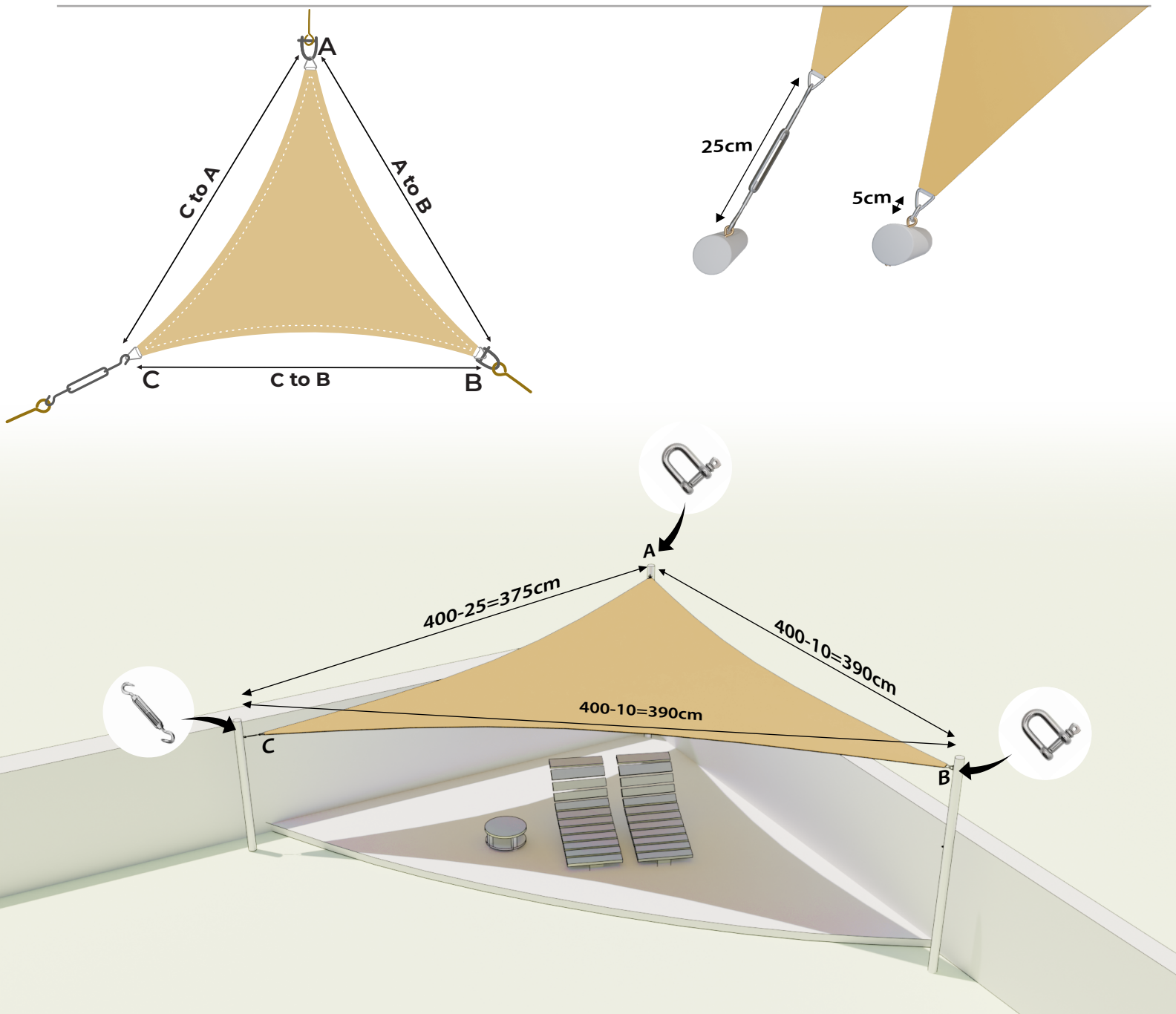

How to measure for Four sided Shade Sail ?

(with additional accessories Turnbuckle & D-Shackle)

For a Four sided shade sail, it is recommended to use a d-shackle on two corners and a turnbuckle on other 2 corner. This provides stability and adjustability.

Leave a 5cm gap between the two anchor points where the d-shackles will be attached. This allows for proper installation.

Leave a 25cm distance between one anchor point and the shade sail buckle. This accounts for slight fabric stretching.

For example, if you want to cover an area of 400cm x 400cm x 400cm x 400cm, then the measurement for the shade sail will be A-B should be 390cm, B-C should be 375cm, C-D should be 390cm and D-A should be 375cm here also the diagonal is optional.

Attach the shade sail directly to corners A and B without any gaps. Use a turnbuckle on corner C to provide tension and adjustability to the shade sail.

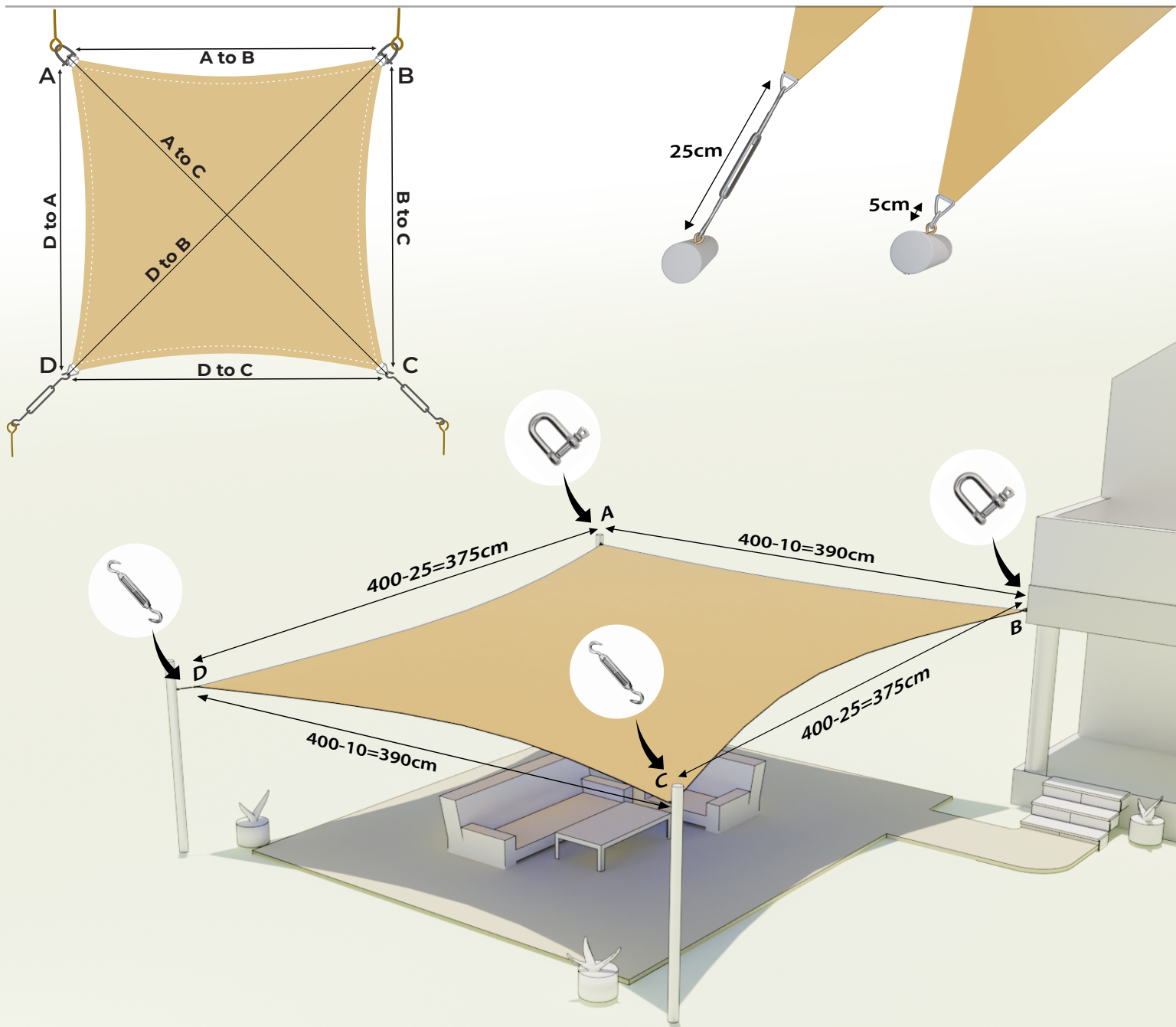

How to measure for Five sided Shade Sail ? (with additional accessories Turnbuckle & D-Shackle)

For a Five sided shade sail, it is recommended to use a D-shackle on two corners and a turnbuckle on other 3 corner. This provides stability and adjustability.

Leave a 5cm gap between the two anchor points where the d-shackles will be attached. This allows for proper installation.

Leave a 25cm distance between one anchor point and the shade sail buckle. This accounts for slight fabric stretching.

